

FOR YOUR SAFETY

This sprayer operates with liquid under pressure. Failure to observe cautions and follow instructions for use and maintenance can cause tank, hose or other parts to become corroded, weakened, and/or burst. This can result in serious injury or property damage from forcible ejection of parts or high-pressure discharge of spray material. Do not use any flammables or boiling liquids in this sprayer as it is not designed nor intended for such use. Some spray materials can ignite or explode. Do not spray in an enclosed space, near an open flame such as found in a bbq grill or water heater, near an electric motor or open switch, or any source of heat. Do not smoke while spraying. Use of flammables could result in serious injury or property damage from unintended ignition or explosion. Do not use any caustics or acids in this sprayer, since these can damage or weaken the sprayer and its parts, resulting in serious injury or property damage. Keep out of reach from children and pets. Always read and follow directions on the spray material container, including the need for protective clothing. Before using your sprayer, thoroughly inspect both inside and outside of the sprayer and do not pressurize sprayer if tank, hose or other parts appear to be damaged, discolored, brittle, excessively soft or loose. Do not pressurize with any mechanical device such as an air compressor, since this can create dangerous pressure and bursting of parts and result in serious injury. Wear long-sleeved shirt, pants, gloves, goggles or similar protective clothing when spraying. **PROP 65 WARNING:** This product can expose you to chemicals, including lead and/or Di(2-ethylhexyl)phthalate (DEHP), which are chemicals known to the State of California to cause cancer and birth defects or other reproductive harm. For more information go to www.P65Warnings.ca.gov. **Wash your hands after handling this product.**

LIMITED WARRANTY

Walmart Inc. warrants to the original consumer purchaser of this product at retail that it is free from problems in materials and workmanship for the period of 2 years (1 Gallon) and 5 years (2 Gallon) from the original date of purchase. This warranty does not apply to damage to the product resulting from accident, misuse, neglect, alteration, modification, tampering, or failure to follow instructions supplied with the product. This warranty does not cover normal wear and tear of o-rings or seals, and the warranty shall be void if the product is used commercially. If the product or any part of it should malfunction within the warranty period, call 1-855-481-2977. Valid only in North America. You must retain your sales receipt as proof of the date of purchase and include it with any return of the product.

WALMART INC. EXCLUDES LIABILITY UNDER THIS WARRANTY FOR ANY AND ALL INCIDENTAL AND CONSEQUENTIAL LOSS OR DAMAGES.

HOW TO ASSEMBLE

A. HOSE TO TANK ASSEMBLY (may be pre-assembled)

IF NOT:

1. Insert the siphon tube approximately 1/2" into the hose insert, until fully seated, otherwise sprayer will spray only air.
2. Lubricate the black o-ring on the hose insert and then push (2a) into the threaded tank nipple until fully seated.
3. Screw hose nut onto threaded tank nipple.

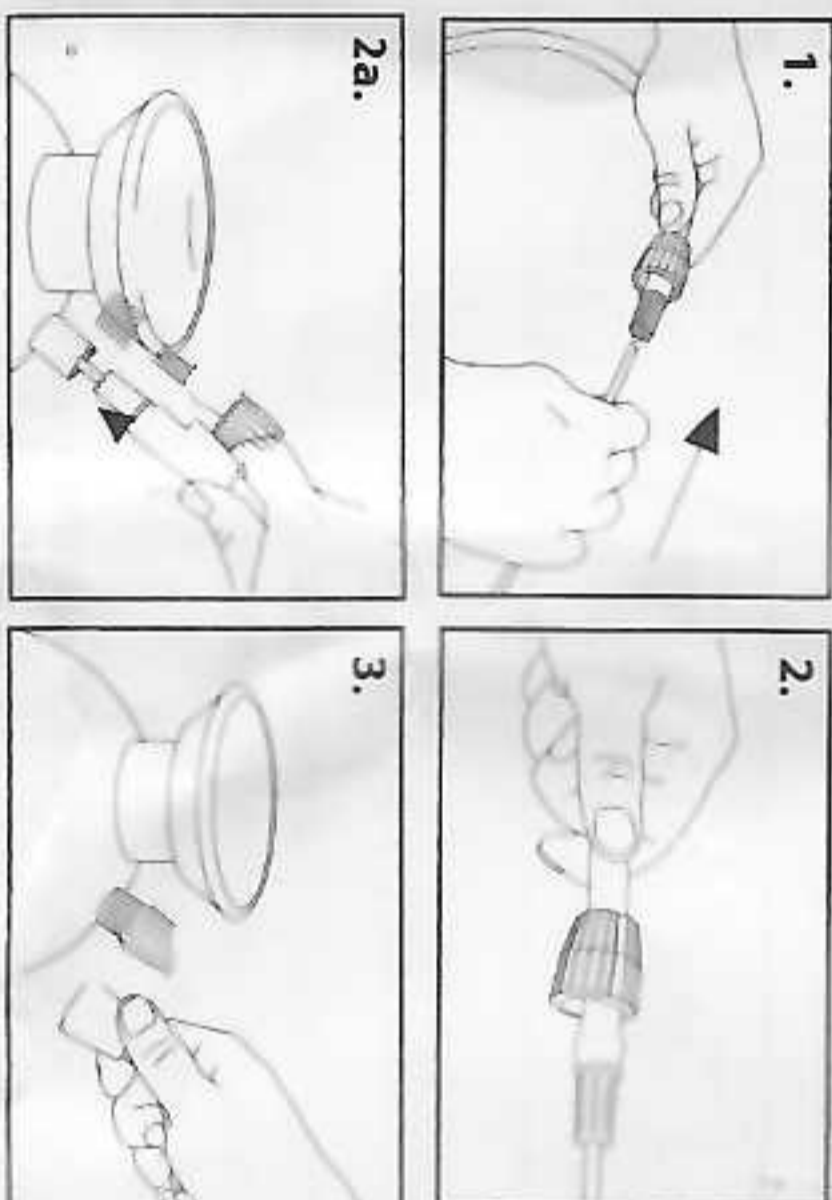

B. FLOW CONTROL TO HOSE (may be pre-assembled) IF NOT:

1. Remove the flow control hose nut from the flow control and slide over the hose.
2. Push the hose over the pointed end of the flow control until it touches the threads.
3. Screw the flow control hose nut onto the flow control. Firmly hand tighten.

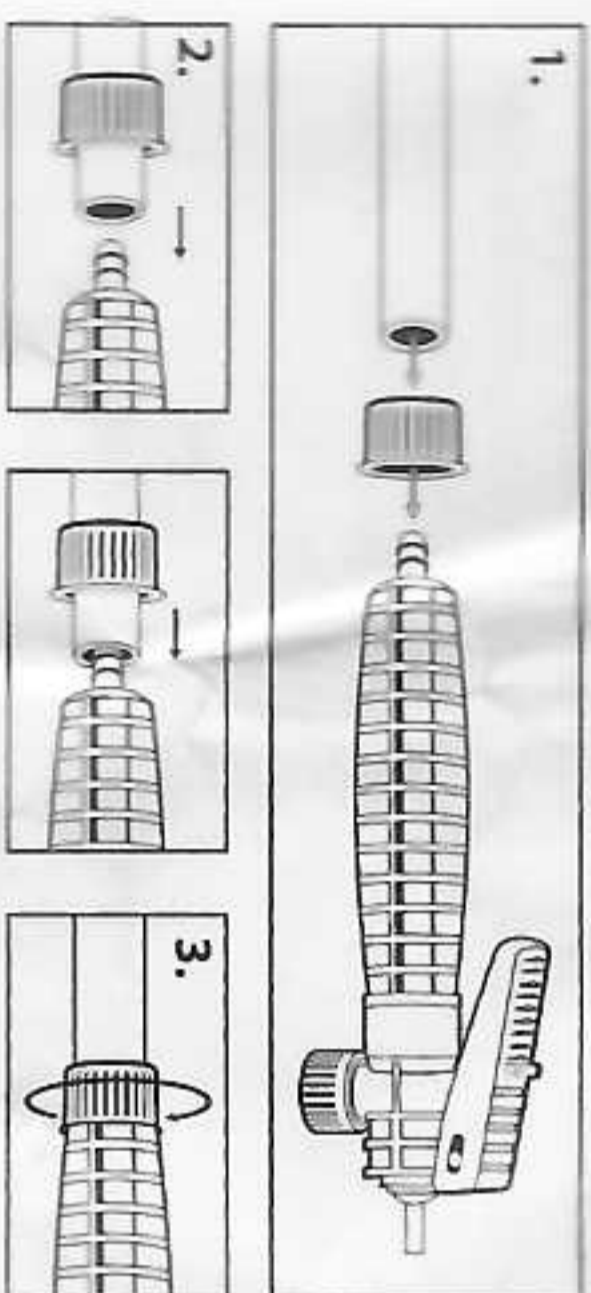

C. WAND TO FLOW CONTROL

1. Push the wand into the flow control until it stops.
2. Slide the o-ring down until it touches the flow control.
3. Screw the wand nut onto the flow control. Firmly hand tighten.



HOW TO FILL

- A. Pour measured amount of spray material into the open tank. Follow label directions on spray material container for amount to use.

- B. Add water as directed. Do not fill beyond the max fill line.

- C. Insert pump and turn clockwise to seal. Do not over tighten.

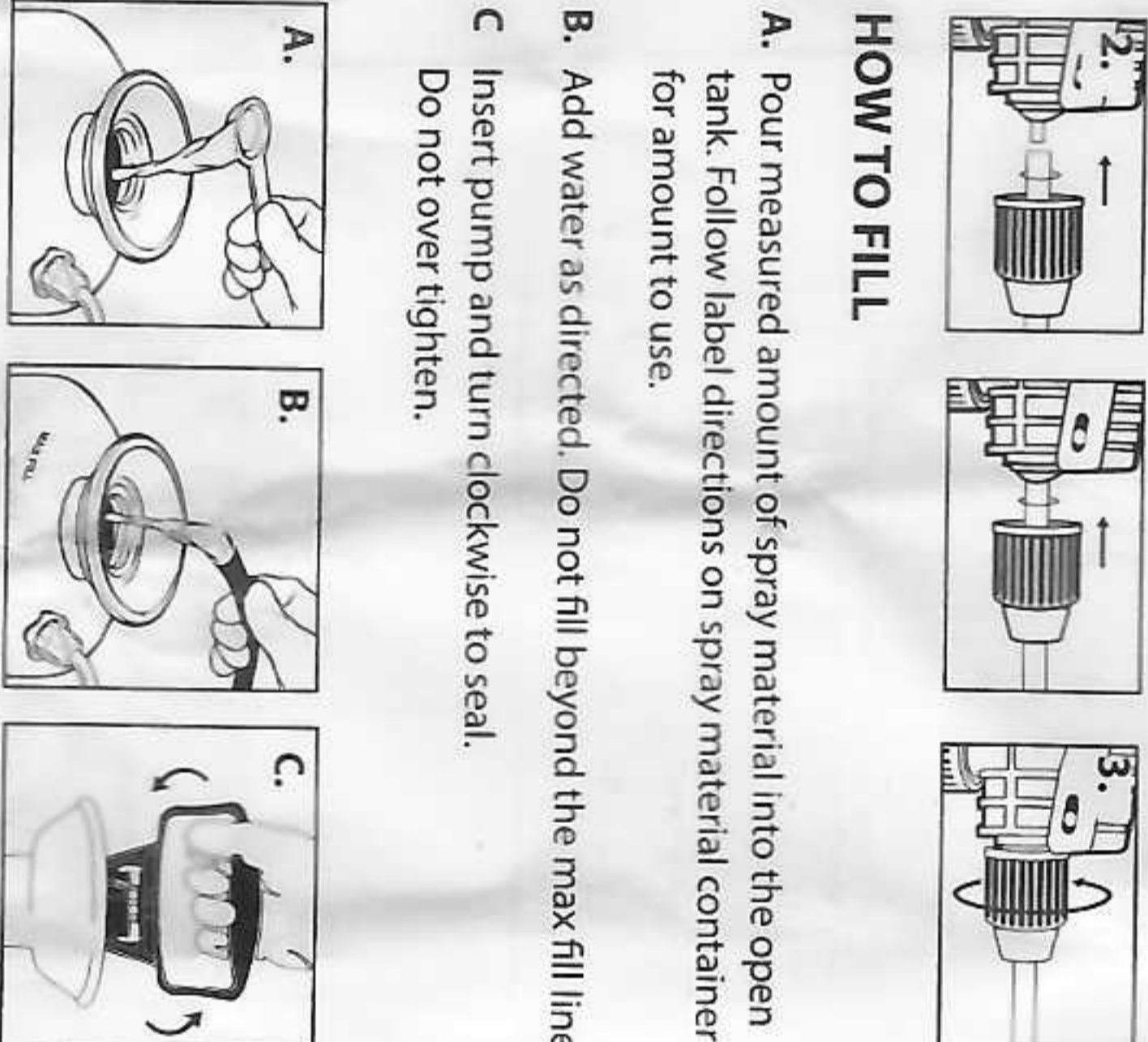

HOW TO PRESSURIZE

Unlock pump handle by pushing down and turning handle. Do not unscrew pump cap or remove pump. Using the handle, pump up and down. The more you pump, the more pressure you will build up inside the tank. When it becomes difficult to pump, your tank has reached maximum pressure. Do not stand so your head is over pump.

- Use low pressure (fewer strokes) for a coarse spray.
- Use high pressure (more strokes) for a fine mist or a long-reaching stream.

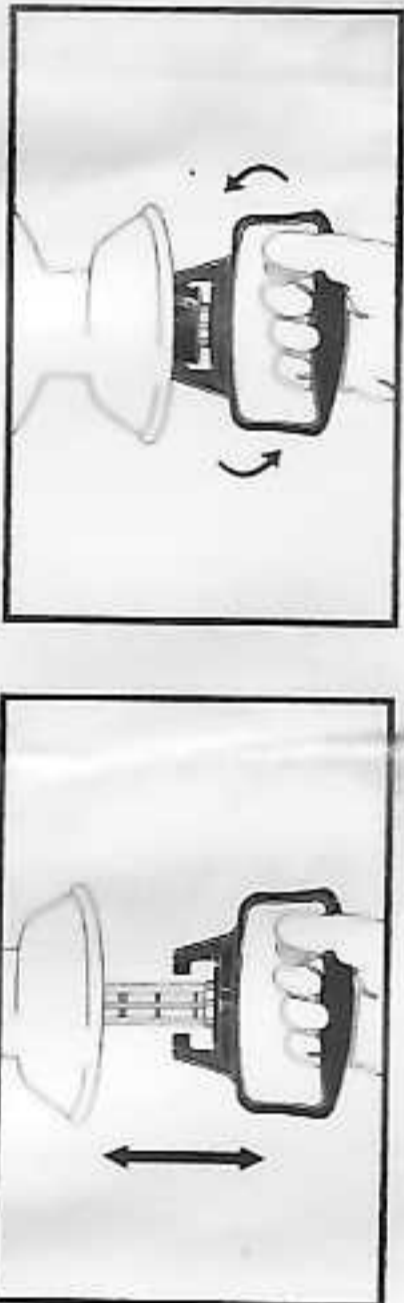

HOW TO SPRAY

A. SPRAYING

1. To start spraying, squeeze the flow control lever.
2. To stop spraying, release the flow control lever while pulling back on the lever.
3. To spray continuously, squeeze the flow control lever and slide forward to lock on.

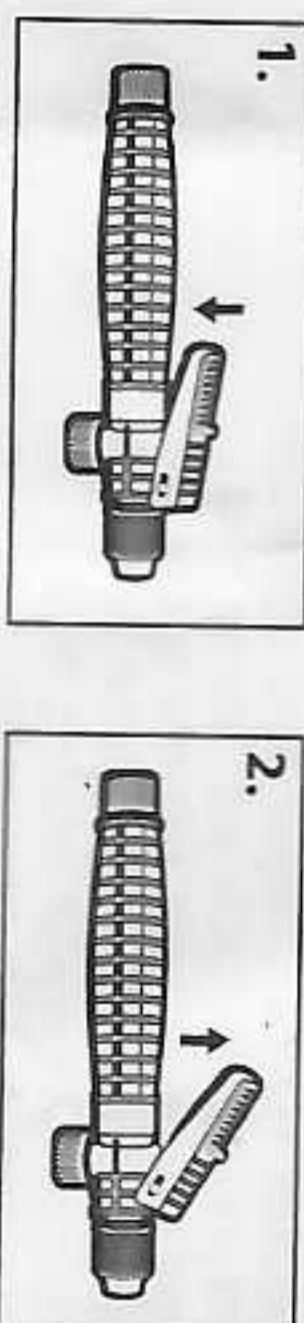

Model 1401E: Tighten nozzle for fine mist; Loosen nozzle for coarse or long range.

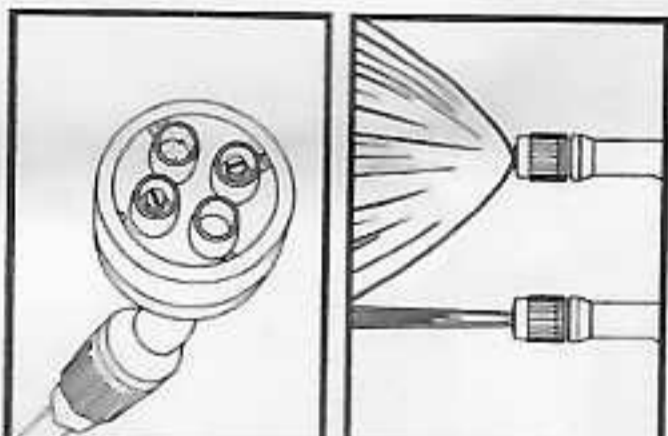

Model 1102E: This contains the Four-Way Cluster[™] nozzle - Choice of four selectable spray patterns; shower, stream, horizontal fan and vertical fan.

HOW TO RELEASE PRESSURE

A. RELEASING PRESSURE

1. This sprayer is equipped with a pressure release valve on the tank. To release pressure twist the top portion, of the valve, clockwise until it clicks. Twist valve clockwise, again, to reseal. Then remove pump.
2. ALWAYS RELEASE pressure in sprayer before servicing.
3. NEVER leave pressurized sprayer unattended.

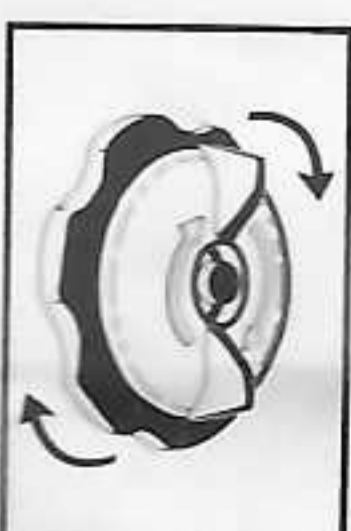

SERVICE AND MAINTENANCE

Clean and dry your sprayer after every use to greatly prolong its useful service life. Many spray materials will harden if left in the sprayer and plug up the nozzle, shut-off valve or supply tube. The soft parts, O-rings and gaskets, will ultimately wear out and need replacing, just like the oil filter on your car, for example. How often they need replacing depends on how much you spray, the spray materials you use and whether or not the sprayer is regularly cleaned after use. Call 1-855-481-2977 to obtain genuine replacement parts. If you leave your sprayer in the garage over Winter, particularly in northern areas, the soft parts may dry out and need servicing before you use your sprayer for the first time in the Spring.